

SYMBOL	DESCRIPTION
□	WALL MOUNTED LIGHT FITTING
○	CEILING LIGHT POINT
■	EXTERIOR 2D BULKHEAD LIGHT
◆	BULKHEAD / CEILING MOUNTED LOW VOLTAGE FITTING
▬	TWO LAMP SURFACE MOUNT FLOURESCENT CEILING LIGHT WITH DIFFUSER
⏏	15 AMP 3-PIN PLUG POINT. HEIGHT FROM FLOOR AS SHOWN
⏏	15 AMP DOUBLE 3-PIN PLUG POINT. HEIGHT FROM FLOOR AS SHOWN
⏏	STOVE PLUG POINT
⊕	GEYSER CONNECTION POINT WITH ISOLATOR
•	LIGHT SWITCH 1m FROM FFL
☒	INTERCOM
⏏	100 x 100 TELEPHONE OUTLET BOX WITH DRAW WIRE AND BLANK COVER PLATE.
⏏	MAIN DB - SEE NOTE.
🔔	ELECTRIC DOORBELL WITH PUSH BUTTON
⏏	ELECTRIC EXTRACTOR FAN COUPLED TO LIGHT SWITCH
📺	TELEVISION POINT

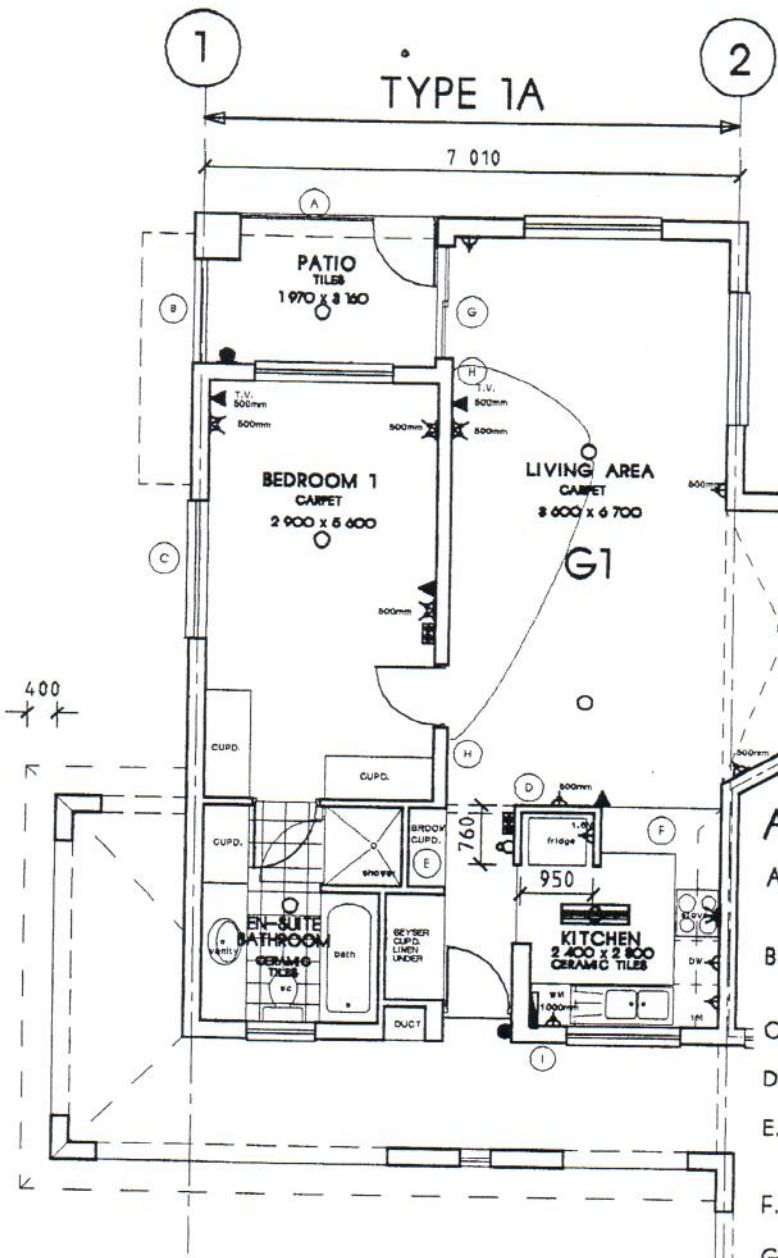

- ### AMMENDMENTS - UNIT G1
- A. ENCLOSE THE PATIO WITH AN EXTERNAL DOOR.
 - B. ADD PANEL OF GLASS BLOCKS 200 x 200
 - C. MOVE EXTERNAL WINDOW TO BEDROOM.
 - D. ENLARGE FRIDGE RECESS
 - E. CREATE BROOM CUPBOARD BEHIND SHOWER.
 - F. ALL COUNTER TOPS - OAK FORMICA
 - G. REPLACE FRENCH PATIO DOORS WITH SLIDING DOORS.
 - H. DOUBLE SWITCHED CIRCUITS
 - I. WASHING MACHINE WALLCOCK & SWITCH SLEEVED SWITCH TO BE 100MM ABOVE COUNTER

GROUND FLOOR PLAN
UNIT G1

CLIENT **NAZARETH HOUSE**

PROJECT **LARMENIER VILLAGE
CAPE TOWN**

DATE **05/08/97**

SCALE **1:100**

PROJECT NO. **18033**

DRAWING NO. **901**

